

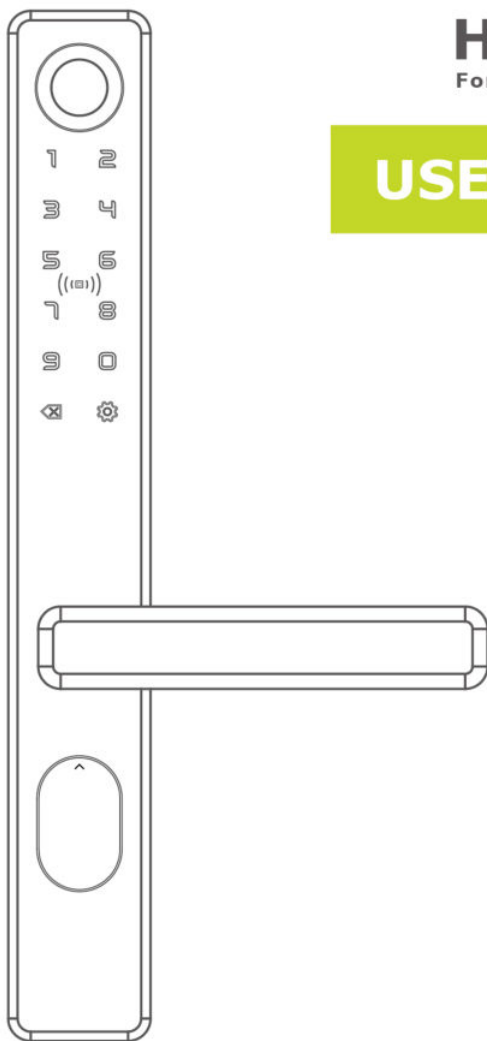

— www.mendock.com —



H5 SMART LOCK

For Aluminum Profile Doors

USER MANUAL



TTLock APP



Please read this manual carefully before use



MENDOCK is a brand belongs to **GUANGDONG OLANG SECURITY TECHNOLOGY CO., LTD.**, which is a technology growth high-tech enterprise which incorporates development, production and sales. High grade smart door locks and its accessories as mainly products. The factory is located in Xiaolan Town, Zhongshan City, one of the top 100 economic towns in China.

Rated as GUANGDONG HIGH-TECH ENTERPRISE, ZHONGSHAN ENGINEERING TECHNOLOGY RESEARCH CENTER, committed to improving product brand, creating a high-grade, high-level corporate image, MENDOCK wins the market through fashionable design, high-quality materials, exquisite craftsmanship and good service.



Accessories Composition

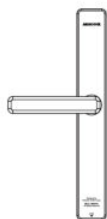

BACK PANEL

×1

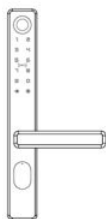

FRONT PANEL

×1

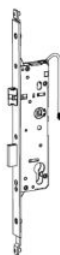

MORTISE LOCKCASE

×1



STRIKE PLATE

×1



CYLINDER

×1



BACKUP KEY

×2

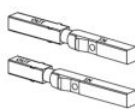

SPINDLE

×2



ROD NUT

×2

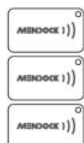

M1 CARD

×3



FIXING BAR

×1



SCREWS

×8



USER MANUAL

×1



CLEANING KERCHIEF

×1

Appearance & Specification

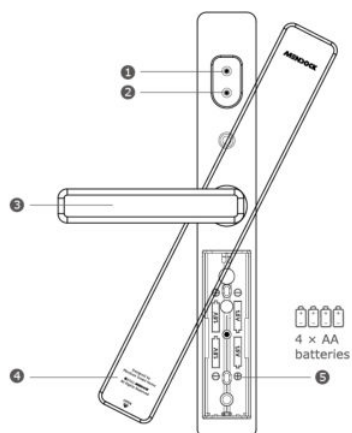

Back side

- ① Setting Button
- ② Reset Button
- ③ Inner Handle
- ④ Back Cover
- ⑤ Battery Compartment

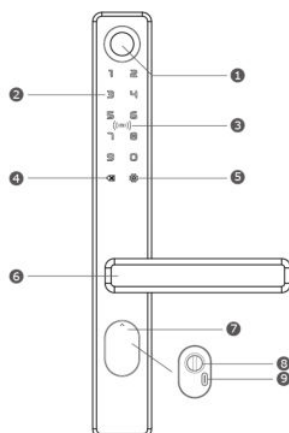

Front side

- ① Fingerprint Sensor
- ② Screen Keypad
- ③ Card Sensor
- ④ Return (Backspace)
- ⑤ Enter (Confirm)
- ⑥ Exterior Handle
- ⑦ Cylinder Cover
- ⑧ Cylinder
- ⑨ Backup Power (Type-c)

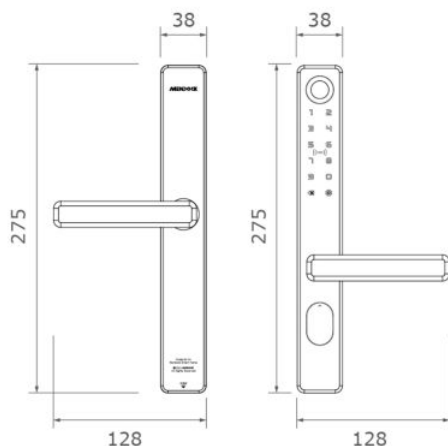

(Unit: mm)

Tools Needed

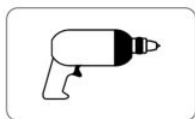

Electrodrill

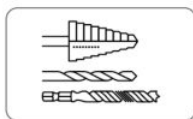

Drill bits

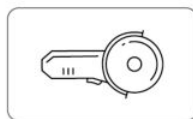

Metal cutting machine

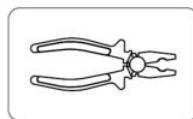

Pliers

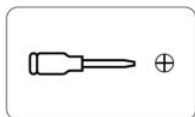

Screw driver



Tape measure



Pencil



Goggles

Check your door thickness

1. This lock fits **XINGFA 55 series** (55mm thickness) aluminum profile doors. For other aluminum door style, we might have to change some accessories to fit.
2. Please check your aluminum door style to ensure it's available to install this lock.

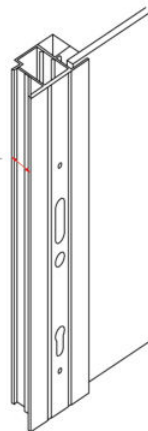

Choose spindle

Spindle #1:

(OUT 40mm + IN 45mm)



For Outward Opening door

Spindle #2:

(OUT 25mm + IN 60mm)

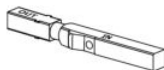

For Inward Opening door

Note: Please ensure to choose correct spindle according to the (Outward / Inward) opening direction of your XINGFA 55 series Aluminum Profile Door!

Installation

Door Opening Direction

LEFT INWARD OPENING DOOR

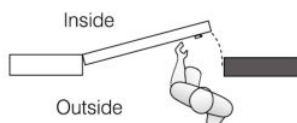

RIGHT INWARD OPENING DOOR

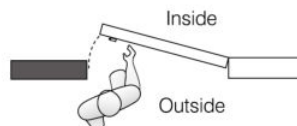

LEFT OUTWARD OPENING DOOR

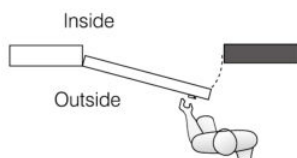

RIGHT OUTWARD OPENING DOOR

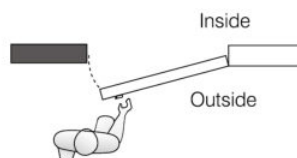

Adjust direction for Lockcase

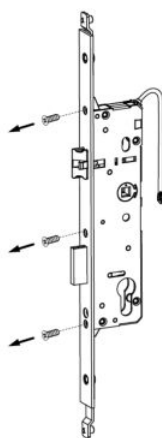

1

Take out 3 screws to remove the Forend Plate



2

Turn the Latch 180°

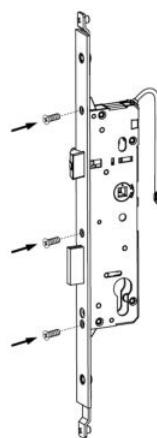

3

Assemble the Forend Plate back

Adjust direction for Handle

Front handle

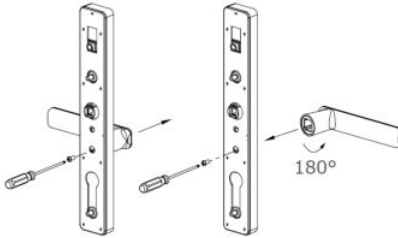

Back handle

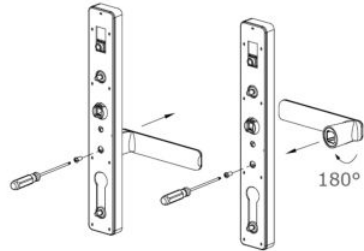

- Step-1. Unscrew and take out the Handle;
Step-2. Turn the Handle 180°;
Step-3. Re-fix the Handle and screw it tightly.

Installation Diagram

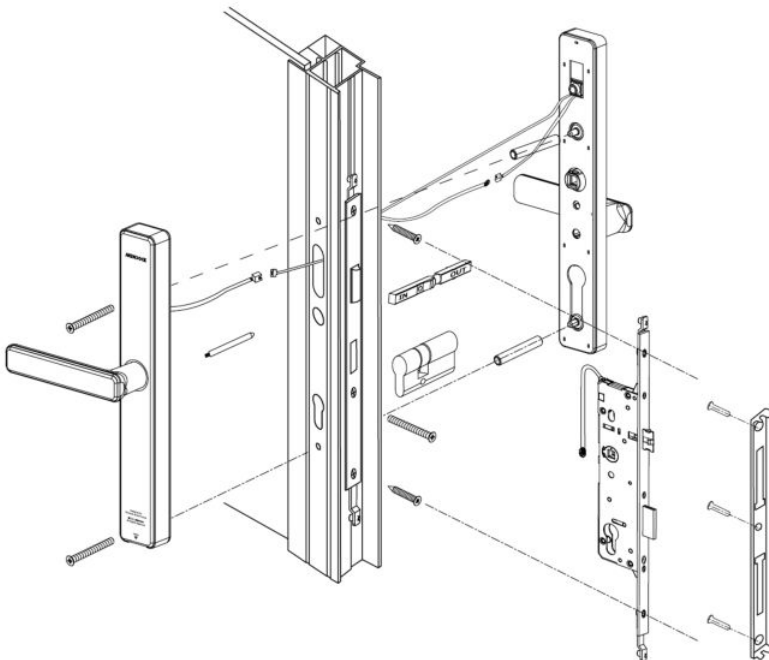

Installation

1

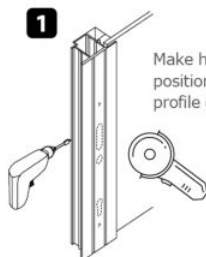

Make holes in the corresponding positions of the aluminum profile door.

2

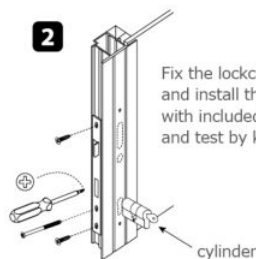

Fix the lockcase and install the cylinder with included screws, and test by key.

3

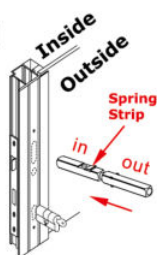

Pay attention to the direction when inserting the spindle. The spindle stamped "IN" means inside of the door; stamped "OUT" means outside of the door.

4



Outside

Be sure to insert the spindle into the lockcase completely. That means, the spring strip must pass the follower completely.

5

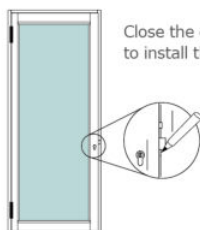

Close the door, mark the lines to install the strike plate.

6

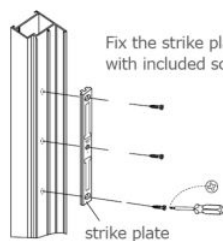

Fix the strike plate with included screws.

7 Connect Cables and Fix Panels

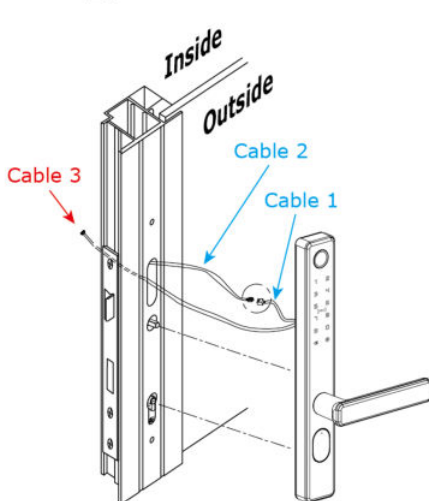

Front side: Cable 1 + Cable 2

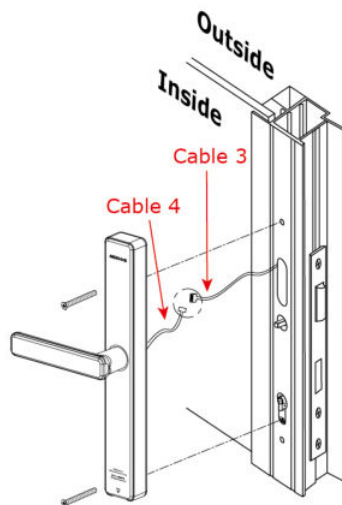

Back side: Cable 3 + Cable 4

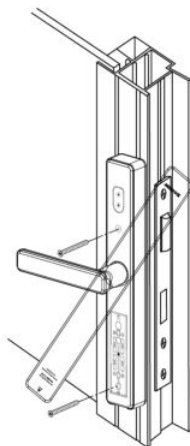

Fix the panels by screws

Tips about Cables

Cable 1: the shorter cable from Front Panel.

Cable 2: the cable from Lockcase.

Cable 3: the longer cable from Front Panel.

Cable 4: the cable from Back Panel.

2. Test



CAUTION

KEEP STANDING
INSIDE THE DOOR
TO TEST THE LOCK!!!

Inside



Keep standing **INSIDE**
the door to test the lock!

Outside

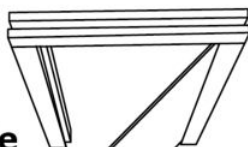

DO NOT stand **OUTSIDE**
the door to test the lock!

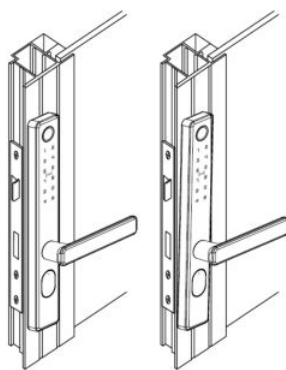
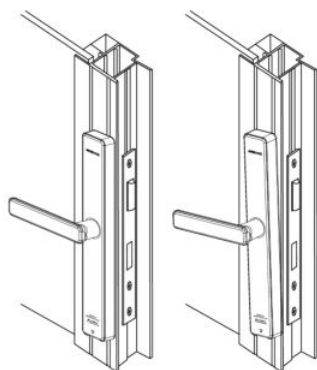

Fix the front panel and back panel properly and keep it parallel to the door edge.

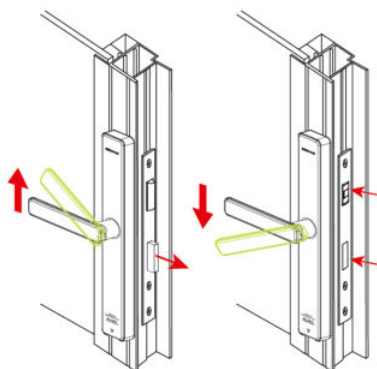

A Test the Inner Handle:

Lift up the inner handle to stretch out the deadbolt smoothly; Push down the inner handle to retract both latch and deadbolt smoothly.

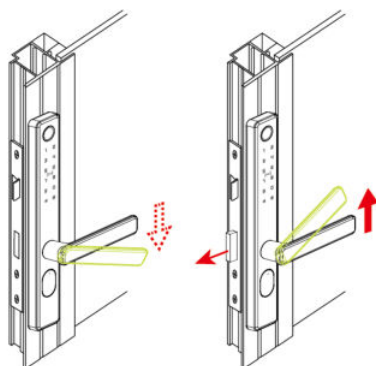

B Test the Exterior Handle:

Push down the exterior handle, it must idle without controlling both latch and deadbolt; Lift up the exterior handle to stretch out the deadbolt smoothly.

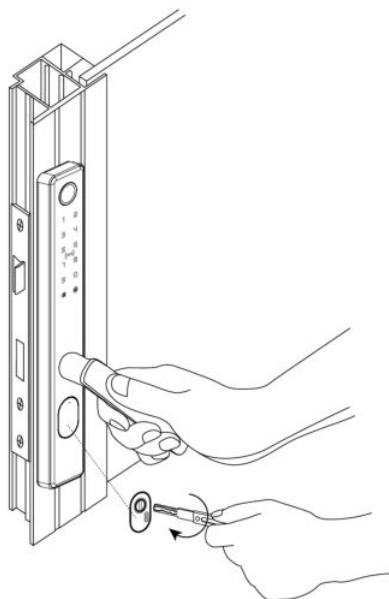

C Test the Backup Key

Find the cylinder cover below the exterior handle;

Push the symbol “^” to uncover it;

Use the Backup Key to test the cylinder, ensure the latch and deadbolt can be stretched out and retracted smoothly.

Tips:

When opening this lock by Backup Key, please you need to use one hand to turn the key and hold it. Then, use another hand to push down the handle to retract the latch and deadbolt.

Test

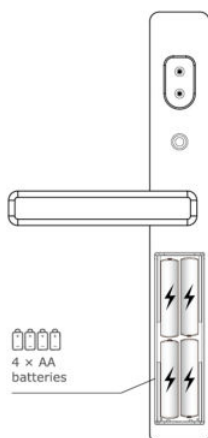

D Check Power Supply

Put 4 pcs AA alkaline batteries into the battery compartment. The motor inside the lock will make a "Zi" sound in several seconds.

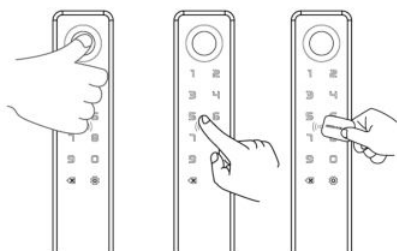

F Test The Verification Methods

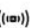
- Press any fingerprint to test, the lock will make "unlocked" voice;
- Touch the keypad to wake up the lock, input the original password 123456, press  symbol to confirm, the lock will make "unlocked" voice;
- Put a M1 card close to  symbol, the lock will make "unlocked" voice.

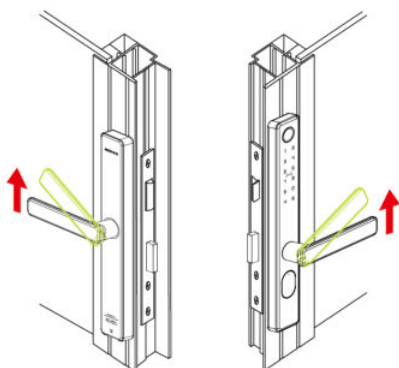

E Stretch Out The Deadbolt

Lift up the inner handle or exterior handle to stretch out the deadbolt.

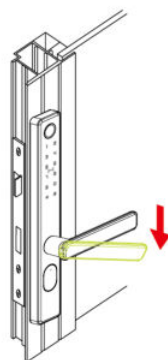

G Unlocked By Handle

After getting through verification by fingerprint / password / card, push down the exterior handle to retract the latch and deadbolt smoothly.

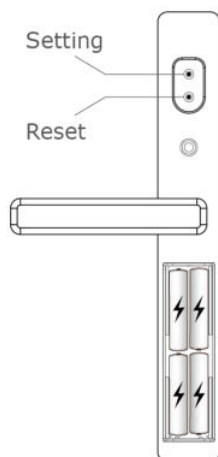

Setting button

With the "Setting" button, you can set up "Administrator Password", and add "fingerprint ID", "password ID", or "card ID" according to the voice prompts.

1. Set up Administrator Password

Press "Setting" → (set a customized Administrator Password) →
⚙️ (confirm) → (input the same password again) → ⚙️ (finish)

2. Set up new user's ID

Press ☒ 80 ⚙️ → (input Administrator Password) → ⚙️ (confirm)
→ (set a new user's password / fingerprint / card) → ⚙️ (finish)

(Tips: password available for 6 - 9 digits)

Reset button

Long press the "Reset" button for 3 seconds, input "000" to reset the lock to factory default status.

**We strongly
recommend
to set up this
lock by APP**

How to delete the user's ID on lock

1. Delete all Card ID

Press ☒ 69 ⚙️ → (input Administrator Password) → ⚙️ (confirm)

2. Delete all Fingerprint ID

Press ☒ 70 ⚙️ → (input Administrator Password) → ⚙️ (confirm)

3. Delete all Password ID (except the Administrator's Password)

Press ☒ 71 ⚙️ → (input Administrator Password) → ⚙️ (confirm)



How to change the voice language

Step-1. Press ☒ → 3 9 → ⚙️ (confirm)

Step-2. Input the verification code → ⚙️ (confirm)

Step-3. Press "1" to select Chinese voice → ⚙️ (finish)

Press "2" to select English voice → ⚙️ (finish)

Tips about "verification code":

Under factory default status, the verification code is 123456;

After setting up administrator, the verification code is the administrator's password.

1. Download & Register the APP



TTLock APP



1-1

Download the "TTLock" APP in
APP Store / Android Market / Google Play

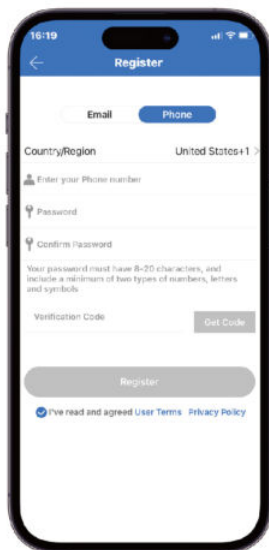
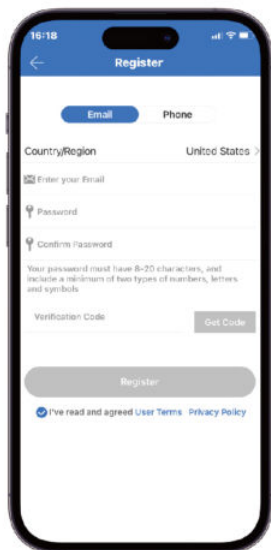

1-2

Register by Mobile Phone Number or Email address

2. Search & Add the lock

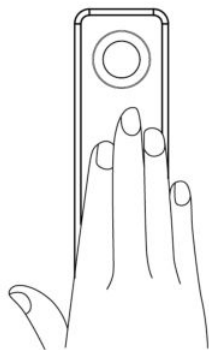

2-1

Touch the keypad to keep the lock under wake up status during searching and pairing process.

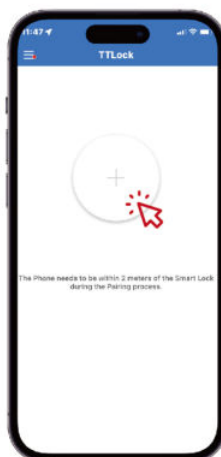

2-2

Keep the mobile phone within 2 meters to the lock during searching & pairing process. (Make sure the Bluetooth is enabled)

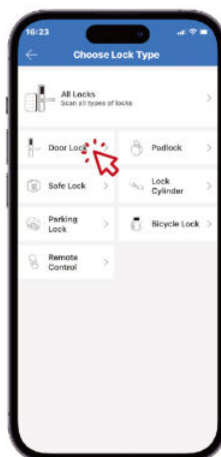

2-3

Search and find the lock, the lock default name is "MDK_XXXXXX"



2-4

After pairing successfully, you can assign a customized name for the lock, for example "My home".

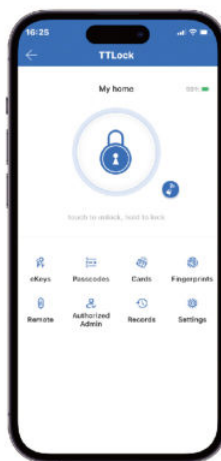

3. Add Password ID

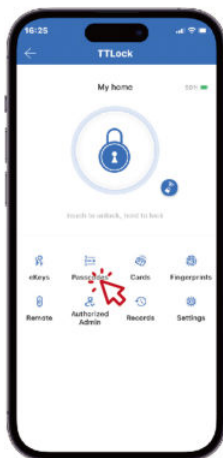

3-1

Tap "Passcodes" to create password ID.



3-2

Tap "Custom" to create a customized password. Set up the valid period or make it permanent. You can also assign a name for the password, for example "Dad's password".
(Tips: password available for 6 - 9 digits)

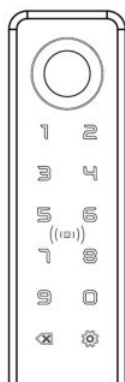
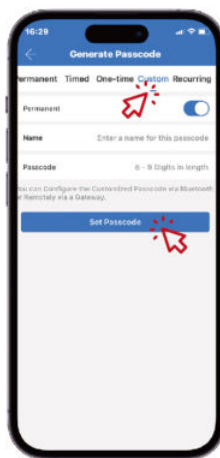

3-3

Test the password

Password Anti-peep Function

XXXXXX	123456	XXXXXX
random digits	correct password	random digits

Before & After inputting correct password, you can input some random digits to perplex the peeper.

(Should not exceed 16 digits totally)

More functions about Password setting are available in the APP

4. Add Card ID

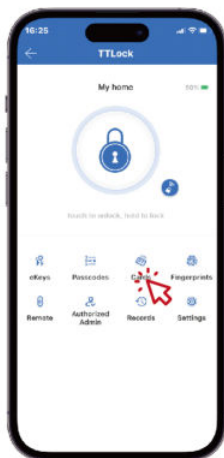

4-1

Tap "Cards" to create card ID.



4-2

Tap "Add Cards" to continue.

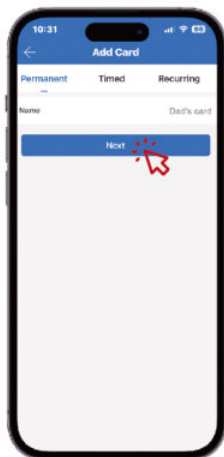

4-3

Assign a name for the card, for example "Dad's card". Tap "Next" to continue.

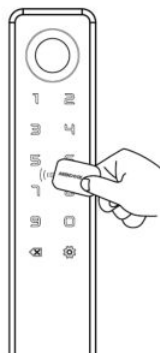

4-4

Put the card close to symbol (III) to finish.

More functions about Card setting are available in the APP

5. Add Fingerprint ID

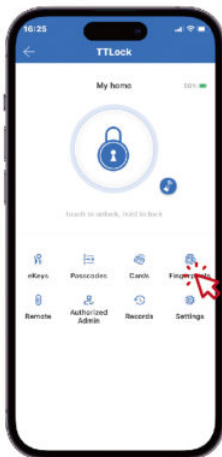

5-1

Tap "Fingerprints" to create fingerprint ID.



5-2

Tap "Add Fingerprint" to continue.

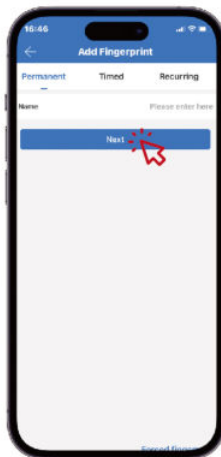

5-3

Assign a name for the fingerprint, for example "Dad's fingerprint".



5-4

Tap "Start" to continue.

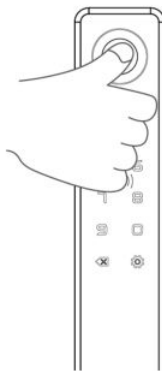

5-5

Place and Remove your finger to the sensor 4 times, then finish.

More functions about Fingerprint setting are available in the APP

6. Authorized Administrator

Authorized Administrator through Phone Number or Email. (Timed / Permanent optional)

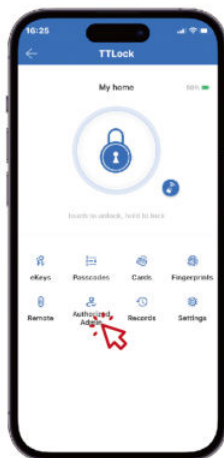

6-1



6-2

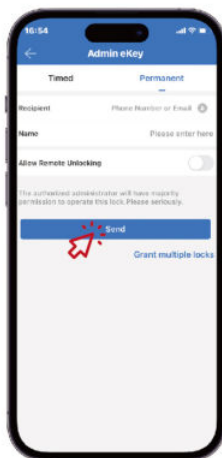

6-3

7. Adjust Lock Sound

Tap "Setting" "Lock Sound" to adjust the lock sound, 4 levels sounds optional. Or you can turn off the lock sound to avoid disturbing.

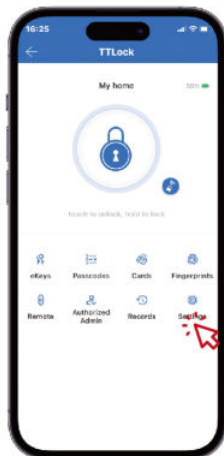

7-1

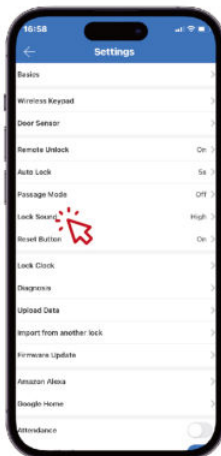

7-2

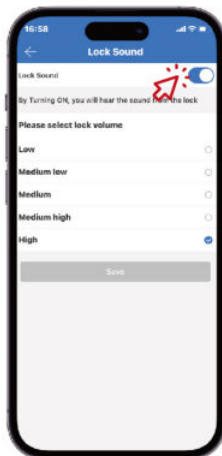

7-3

More functions setting are available in the APP



MENDOCK



Factory in China:

GUANGDONG OLANG SECURITY TECHNOLOGY CO., LTD.

No. #1, Guangfeng Industrial Village, Xiaolan, Zhongshan, Guangdong, China 528415

Tel: +86-180-2206-6695 Email: info@mendock.com <https://www.mendock.com>



Italy Office:

OLANG & MENDOCK LOCK ITALY

Viale dell'Industria, 19 IT35129 Padova - Italy

Tel: +39-049-7360335 Email: info@mendock.it



Nhà phân phối:

CÔNG TY CỔ PHẦN KỸ THUẬT THƯƠNG MẠI AN HẢI

Địa chỉ: Số 1 Đường số 9, Khu đô thị An Phú - An Khánh,

Thủ Đức, Thành phố Hồ Chí Minh.

Mobile: 0908881296 Email: dong.nguyen@anhai.com.vn