

Automatic Smart Lock S1_Installation Manual

(Version: V1.1, Date: 2024.07.04)

I. Installation Pre-Check

1. Suitable Scenarios: Villas, family security doors, exterior doors, offices, etc.
2. For security doors, it is recommended to choose door locks with top and bottom bolts; for wooden doors, it is recommended to choose door locks without top and bottom bolts.
3. Please ensure that the opening direction of the purchased product matches your actual needs.
4. For centered installation, the door thickness should be between 40~120mm; for off-center installation, please check if the specifications of the lock cylinder, handle square iron, pull-through screws, and square rod of the knob are suitable, or consult the dealer.

Note:

1. This manual uses a right-handed internal opening as an example to describe the installation method of the door lock.
2. Standard for Inductive Password Anti-theft Lock Series:
GA 374-2019 General Technical Document for Electronic Anti-theft Locks
GB21556-2008 General Technical Conditions for the Safety of Locks



Power-On Testing

Before installation, connect the power and perform a test to ensure that the panel and lock body are fully functional before proceeding with the installation.



Lock Cylinder Testing

After the lock Cylinder is installed, insert the key all the way in and test if it can unlock the lock normally.



Handle Testing

After the lock body is installed, use the handle to test if the lock bolt extends and retracts smoothly.



Door Lock Adjustment

After the smart lock is installed, test if it can unlock normally after powering on. When adjusting the door lock after the overall installation, ensure that the door is in the open position, or there is someone inside the door.

II. Diagram of Door Opening Direction

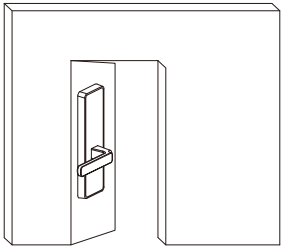

Single Door Left Internal Opening

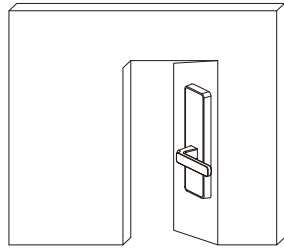

Single Door Right Internal Opening

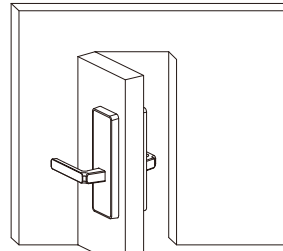

Single Door Left External Opening

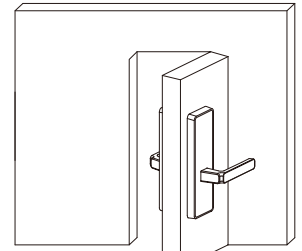

Single Door Right External Opening

The method for changing the direction of the latch when opening the door inward or outward:

1.To interchange the inward and outward opening directions, push the switch plate to the left and rotate the latch 180° to change the direction.

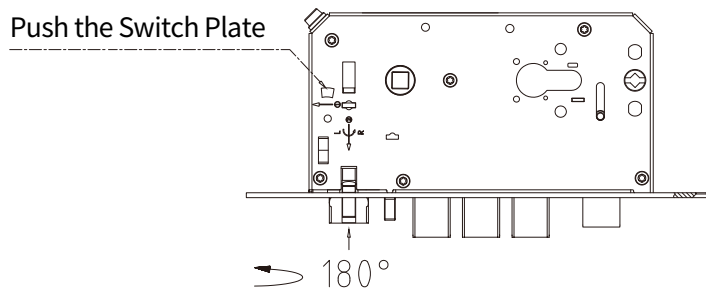

III. Exploded View of Installation

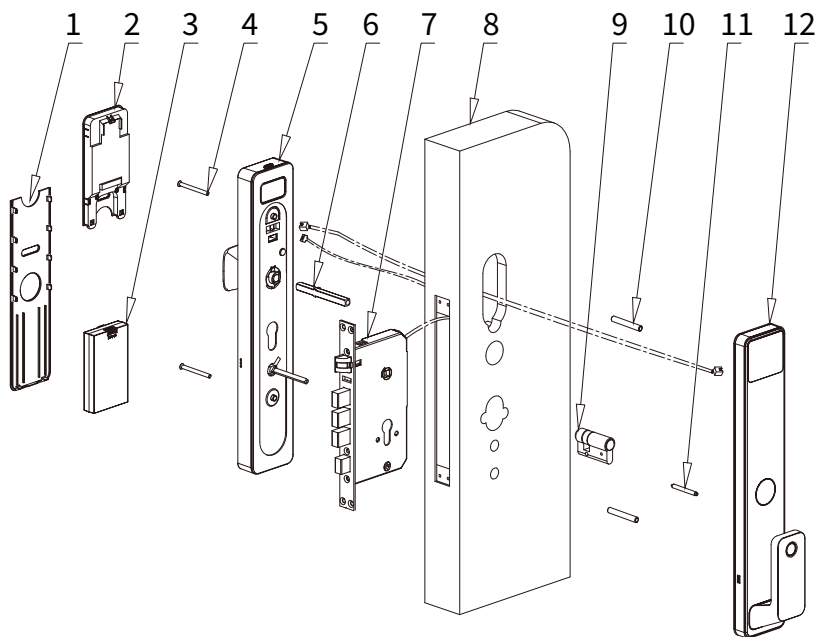

1. Interior Panel Cover, 2. Display Module, 3. Lithium Battery,
4. Pull-Through Screws * 2, 5. Interior Panel Module, 6. Square Rod,
7. Lock Body, 8. Door, 9. Lock Cylinder, 10. Pull-Through Rods * 2,
11. Positioning Rods * 2, 12. Exterior Panel

IV. Door and Frame Rabbet Hole Drilling

1. Measure out the appropriate height (reference value 1.1 meters) and draw a horizontal line as the installation base line.
2. Drill holes according to the paper template requirements.
3. To avoid drilling errors and cracks, it is recommended to drill half of the hole on both sides of the door during drilling.

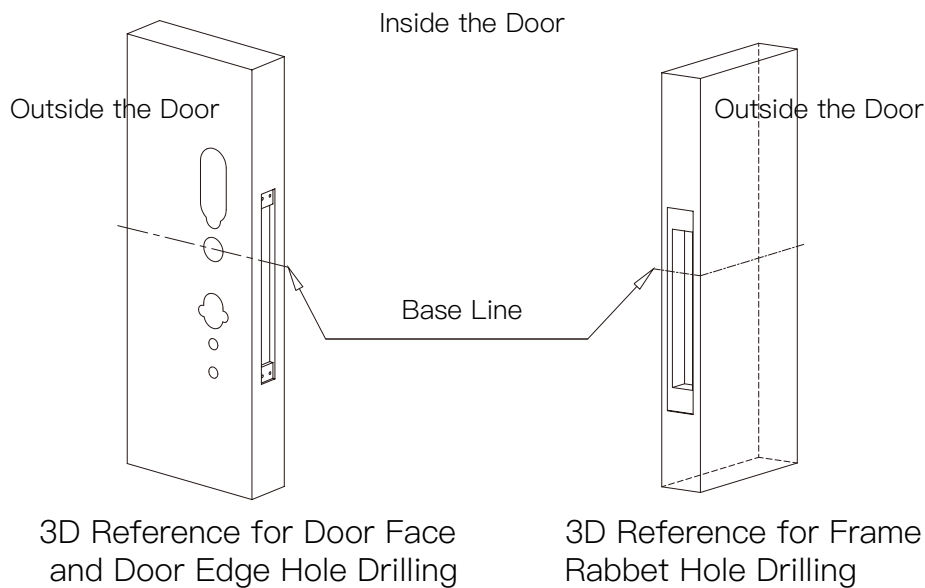

V. Installation of Lock Body and Lock Cylinder

1. Installation of the Lock Body: As shown in line 1, pass the wire through the door face hole and pre-tighten the screws; check if the lock side panel is parallel to the door edge.
2. Installation of the Lock Cylinder: Depending on the actual situation, the square rod can be cut shorter. After tightening the lock cylinder with the lock cylinder screw, remove the key.

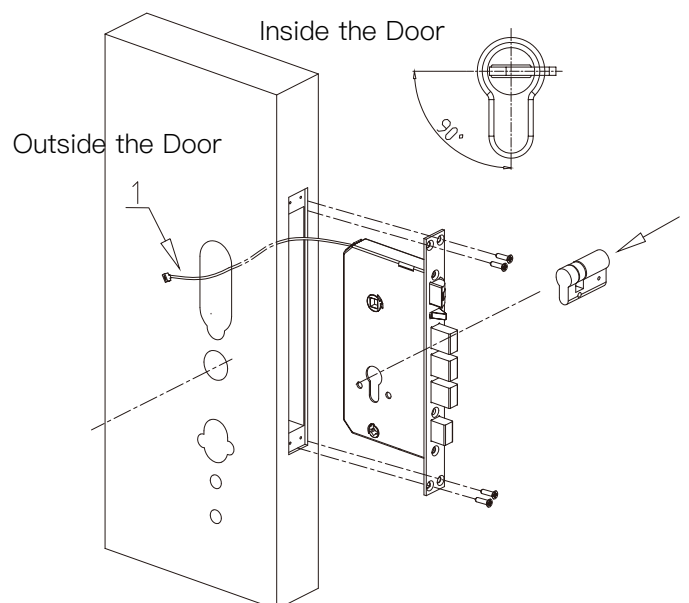

VI. Installation of Exterior Panel, Pull-Through Rods, and Positioning Rods

1. Installation of the exterior Panel: Pay attention to the position of the wire installation:

- Line 1 passes through the elliptical hole outside the door and brings out the wires inside the door;
- The exterior panel is screwed with 2 pull-through rods and 2 positioning rods.

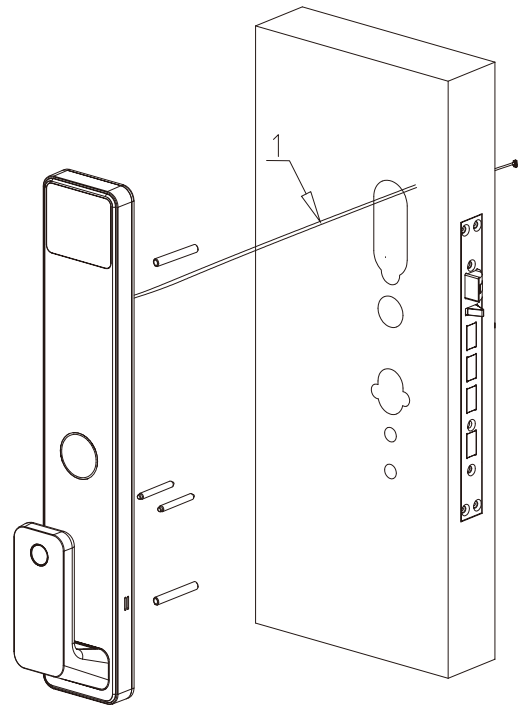

VII. Installation of Interior Panel and Square Rod

1. Line 1 and Line 2 are pulled out from inside the door and stuffed into the door hole that is not pressed by the panel.

2. Install the square rod with its protruding points towards the panel, paying attention to the direction of the square rod; you can cut the square rod shorter according to the actual situation.

3. Install the interior panel, remove the cover,

and tighten the 2 screws with a cross screwdriver. Install in order: pull-through rod – lithium battery – inner panel cover – display module (Note: Do not install the lithium battery or power on until the panel is properly installed).

4. Check if the inner handle can freely extend or retract the square tongue.

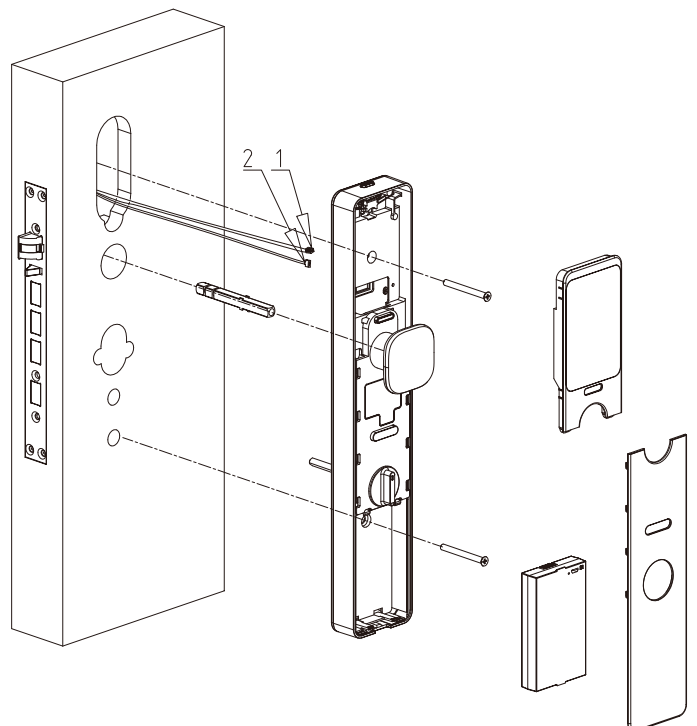

VIII. Functional Testing and Adjustment (Before the installation and adjustment are completed, please ensure that there is someone inside the door)

1. The lock body should be installed firmly, and the lock side panel should be perpendicular to the door face.

2. The exterior panel should be installed firmly, and the panel side should be parallel to the door edge.

3. The latch should extend and retract smoothly; the closing force when closing the door should be light and quick; after closing, the gap between the door should be appropriate.

4. The square tongue should be able to extend and retract flexibly; after closing the door, the square tongue should be able to enter the opposite panel to lock the door smoothly.

5. Rotating the inner handle counterclockwise should be able to extend the square tongue flexibly; rotating the inner handle clockwise can retract the square tongue, latch, and safety tongue.

6. Turning the key outside the door should open the door smoothly; the key should open the door smoothly.

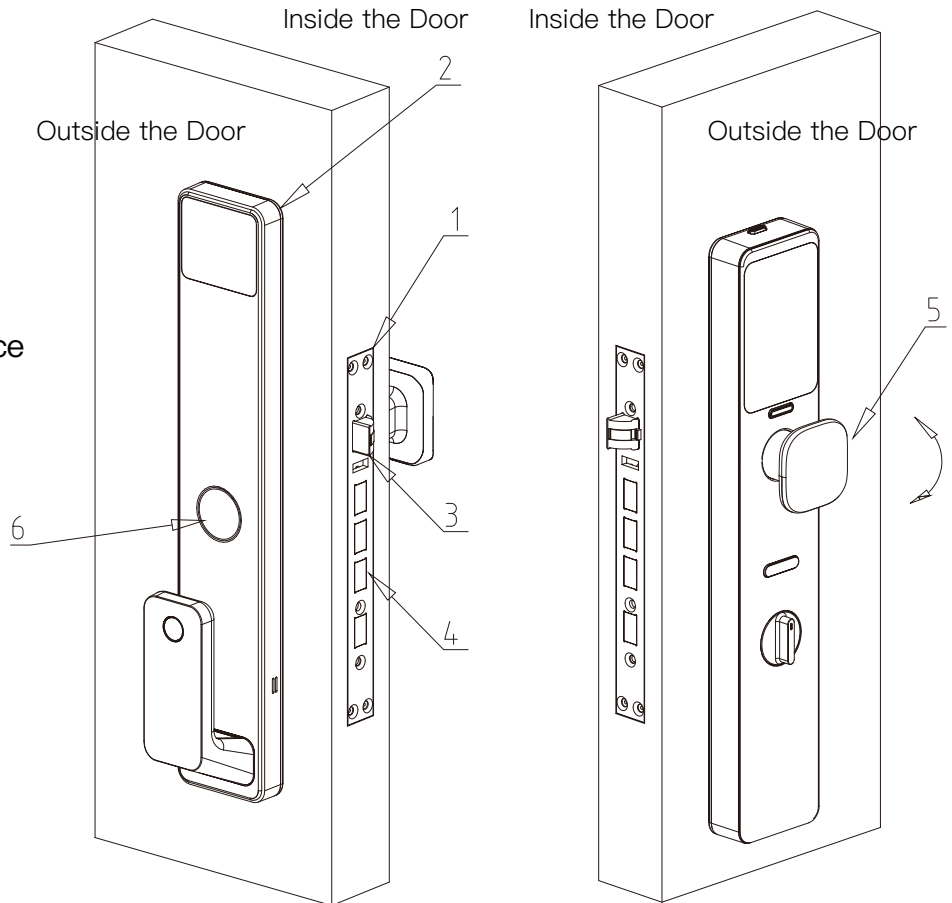

IX. Setting the Door Opening Direction

1. The device is factory-set to open to the left. To switch the opening direction: press and hold the setup button for 2 seconds, then simultaneously press and rotate the handle without releasing until you hear the "left/right" prompt to complete the configuration.

2. Configuration can also be done through the APP after network pairing is completed.

3. Configuration can be done through the APP's device details – Door Lock Security Settings.

X. Determining if Installation is Supported

| Category | Items | Labeling | Conditions | Installable |
|----------|---|----------|------------------------|-------------|
| Size | Width of the Door Lock Panel Position | A | >10cm | YES |
| | Thickness of the Wooden Door | B | >4.5cm | YES |
| | Thickness of the Security Door | | >4cm | YES |
| | Internal and External Door Spacing of the Security Door | C | >9cm(Handle Offset) | YES |
| | | | >16cm(Handle Parallel) | YES |

As shown in the figure:

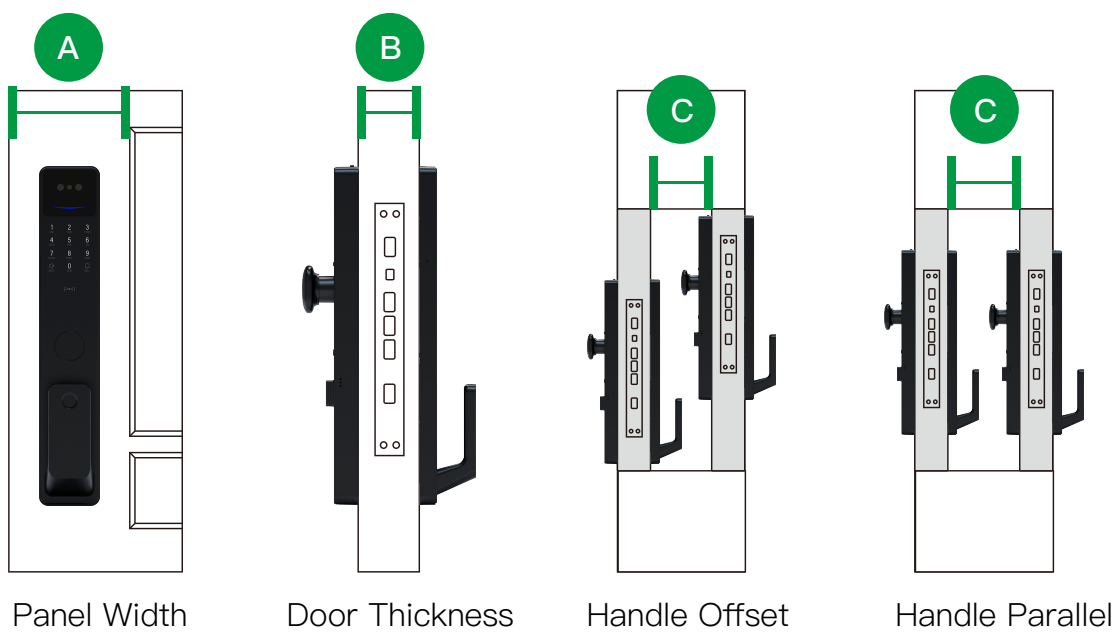

Explanation:

A. The width of the door lock panel position must be greater than 10cm.

B. Installation on wooden doors: the door thickness must be greater than 4.5cm to install.
Installation on security doors: the door thickness must be greater than 4cm to install.

C. If there are internal and external doors, there are requirements for the distance between the internal and external doors, and attention should be paid to whether the handle is offset:
Handle offset: the distance between the external and internal doors must be greater than 9cm to install.
Handle parallel: the distance between the external and internal doors must be greater than 16cm to install.